

JAY FLIGHT

family favorite

DESTINED FOR FUN.



america's family FAVORITE



A FEW OF THE MANY REASONS JAY FLIGHT CONTINUES TO BE THE TOP-SELLING TRAVEL TRAILER

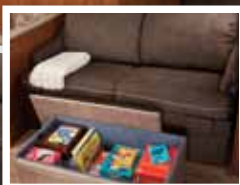

FLEXIBLE FOR FAMILIES

Making the most of space, the standard Flex Dinette features pull-out seating, comfortable ottoman and roomy storage, making this U-dinette a family must.



AMPLE STORAGE

There's no shortage of durable storage thanks to Amish-crafted cabinetry and a 6.3 cu. ft. double-door refrigerator.

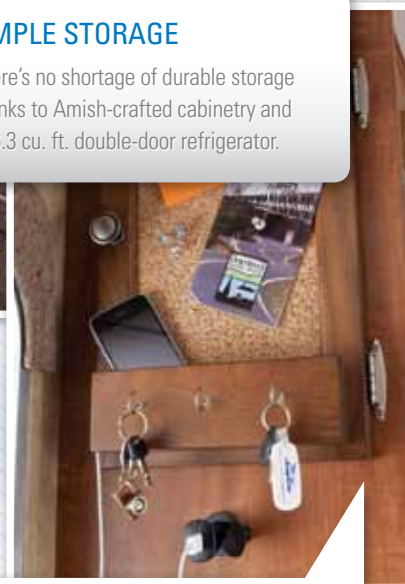

COMMAND YOUR RV

The command center hides all of your controls behind a convenient message board with 12V cell phone charger outlet.



YOU WANT PEACE OF MIND

That's why we offer our exclusive 2-year Co-Pilot Warranty, the industry's best and most comprehensive warranty program.



america's favorite **DESTINATION**

AND ALL THE MANY REASONS YOU'LL WANT TO LENGTHEN YOUR NEXT FAMILY GETAWAY

FULL-FEATURED KITCHEN

You'll forget you're cooking in an RV thanks to an 18 cu. ft. residential-style refrigerator with ice maker, large 60/40 deep-bowl sink with high-rise faucet and stunning Glazed Concord Cherry cabinetry.

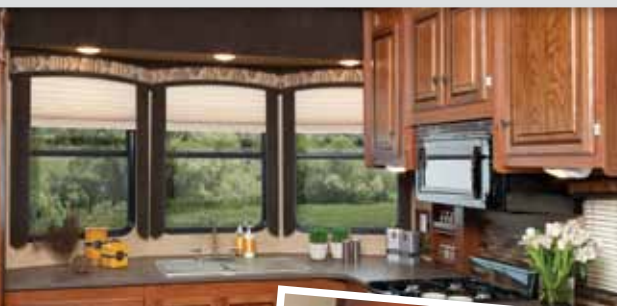

RESIDENTIAL-STYLE ATRIUM

A residential-style atrium, 60" sliding patio door and detachable hitch provide home-like exterior touches.



HIDE-A-BED SOFA

Perfect for family members or overnight guests.



OPTIONAL FIREPLACE

Relax in front of a LedgeStone electric fireplace with brick facade and large HDTV.

WITH YOUR PURCHASE

Every Jayco RV undergoes rigorous quality control testing before it leaves the factory, so you can be confident your new Jayco will continue to provide the ultimate in reliability for years to come.

For a copy of our 2-year limited warranty with full terms and conditions, ask your local Jayco dealer.



TO LEARN MORE ABOUT
OUR QUALITY CONTROL
TESTING, SCAN HERE WITH
YOUR SMARTPHONE.



JAY FLIGHT

america's *family favorite*

Spacious slideouts, well-designed living areas, more than a dozen different floorplans and an endless list of family-friendly features make the Jay Flight travel trailer the perfect fit for any family. And with 75-plus gallons of fresh water, we're certain we can keep up with your family demands, too.





JAY FLIGHT 32TSBH | HAZELNUT



JAY FLIGHT 25RKS | SANDALWOOD



JAY FLIGHT 32TSBH | HAZELNUT

DINNER TIME

Jayco has dinner covered with a 3-burner gas range, a residential-style sink and microwave oven with carousel.

READY TO TOW

Built for families on the go, Jay Flight is packed with more standard towing features, like E-Z Lube axles for easy maintenance and an aerodynamic curved front profile for better gas economy. Once you get there, optional electric stabilizer jacks make setup a breeze.



JAY FLIGHT 32TSBH | HAZELNUT

FLOORPLANS

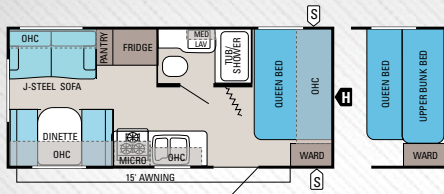

JAY FLIGHT | 19RD

Ext. Length: 23' 1" Ext. Height: 128" Unloaded Wt. (lbs.): 3,970* Sleeps: 4-7

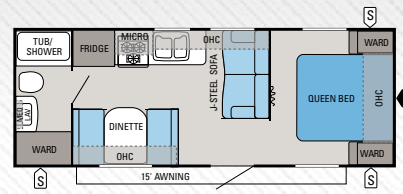

JAY FLIGHT | 22FB

Ext. Length: 26' 5" Ext. Height: 127" Unloaded Wt. (lbs.): 4,150 Sleeps: 4-6

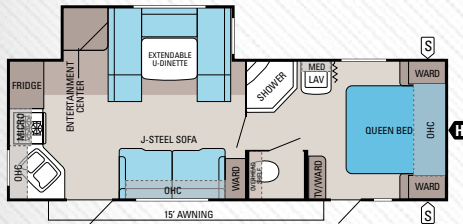

JAY FLIGHT | 25RKS

Ext. Length: 28' 8" Ext. Height: 135" Unloaded Wt. (lbs.): 5,865 Sleeps: 4-6

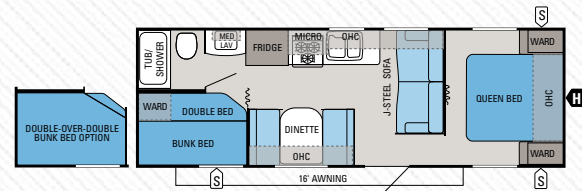

JAY FLIGHT | 26BH

Ext. Length: 29' 1" Ext. Height: 127" Unloaded Wt. (lbs.): 4,570 Sleeps: 7-9

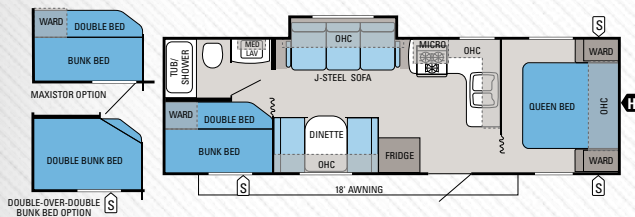

JAY FLIGHT | 28BHS

Ext. Length: 30' 6" Ext. Height: 127" Unloaded Wt. (lbs.): 5,045 Sleeps: 7-9

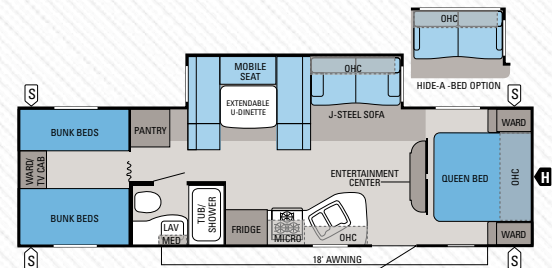

JAY FLIGHT | 29QBH

Ext. Length: 33' 3" Ext. Height: 134" Unloaded Wt. (lbs.): 6,575 Sleeps: 9-10

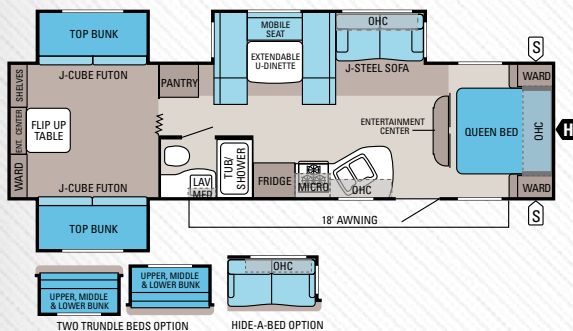

JAY FLIGHT | 32TSBH

Ext. Length: 35' 6" Ext. Height: 134" Unloaded Wt. (lbs.): 7,775 Sleeps: 11-12

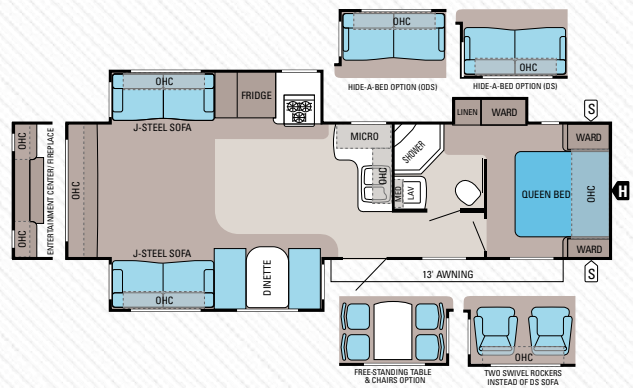

JAY FLIGHT | 33RLDS

Ext. Length: 35' 5" Ext. Height: 134" Unloaded Wt. (lbs.): 7,825 Sleeps: 3-8

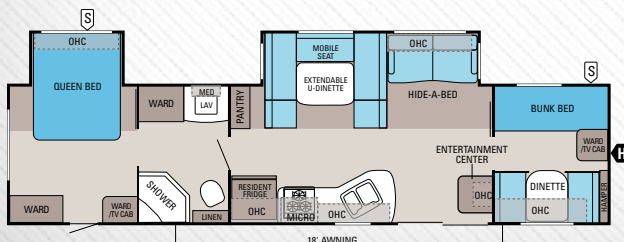

JAY FLIGHT | 36BHDS

Ext. Length: 38' Ext. Height: 134" Unloaded Wt. (lbs.): 7,970* Sleeps: 8-10

S OUTSIDE STORAGE
H TRAILER HITCH
LAV BATHROOM SINK

MICRO MICROWAVE
OHC OVERHEAD CABINETS
FRIDGE REFRIGERATOR
WARD WARDROBE

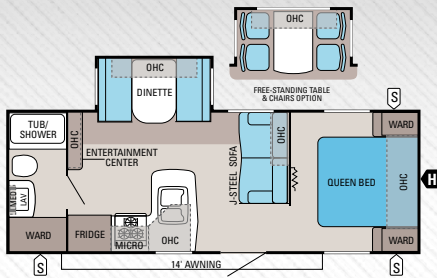

JAY FLIGHT | 24FBS

Ext. Length: 27' Ext. Height: 134" Unloaded Wt. (lbs.): 4,980* Sleeps: 3-6

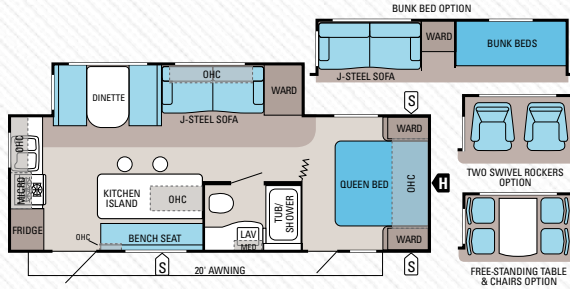

JAY FLIGHT | 26RKS

Ext. Length: 28' 5" Ext. Height: 134" Unloaded Wt. (lbs.): 5,970 Sleeps: 3-6

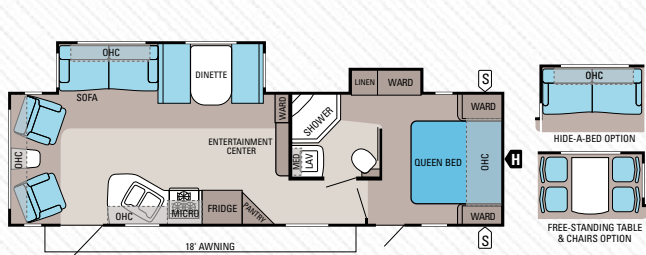

JAY FLIGHT | 29RLDS

Ext. Length: 33' 5" Ext. Height: 134" Unloaded Wt. (lbs.): 6,990 Sleeps: 3-6

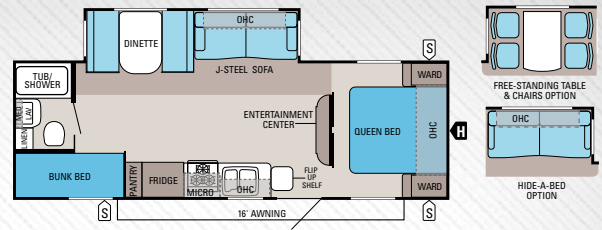

JAY FLIGHT | 25BHS

Ext. Length: 28' 11" Ext. Height: 134" Unloaded Wt. (lbs.): 5,770 Sleeps: 6-8

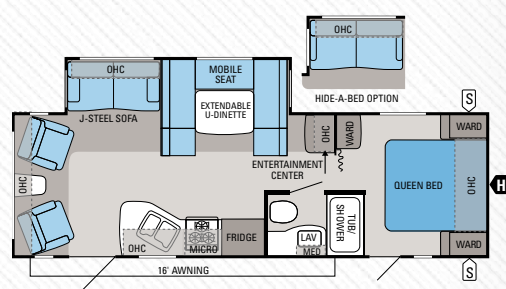

JAY FLIGHT | 26RLS

Ext. Length: 30' Ext. Height: 134" Unloaded Wt. (lbs.): 6,005 Sleeps: 4-6

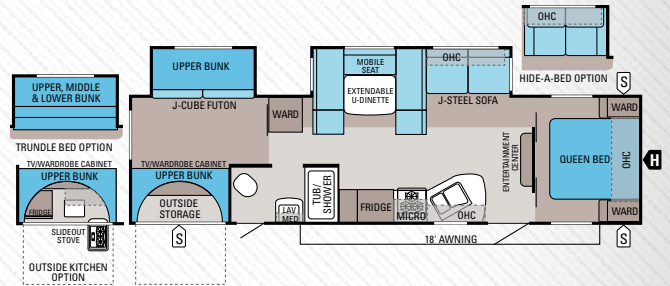

JAY FLIGHT | 32BHDS

Ext. Length: 35' 6" Ext. Height: 134" Unloaded Wt. (lbs.): 7,445 Sleeps: 8-10

SPECIFICATIONS

FLOORPLAN	EXTERIOR LENGTH	EXTERIOR WIDTH	EXTERIOR HEIGHT (WITH A/C)	INTERIOR HEIGHT	UNLOADED VEHICLE WEIGHT (LBS.)	DRY HITCH WEIGHT (LBS.)	GROSS VEHICLE WEIGHT RATING (LBS.)	CARGO CARRYING CAPACITY (LBS.)	FRESH WATER CAPACITY (GAL.) (WITH WATER HEATER)	GRAY WASTEWATER CAPACITY (GAL.)	TOILET/BLACK WASTEWATER CAPACITY (GAL.)
19RD	23' 1"	96"	128"	81"	3,970*	510*	6,200	2,230*	90	32.5	32.5
22FB	26' 5"	96"	127"	81"	4,150	565	6,500	2,350	90	32.5	32.5
24FBS	27'	96"	134"	81"	4,980*	605*	7,500	2,520*	86	32.5	32.5
25BHS	28' 11"	96"	134"	81"	5,770	755	8,180	2,410	86	32.5	32.5
25RKS	28' 8"	96"	135"	81"	5,865	790	8,400	2,535	86	65	32.5
26BH	29' 1"	96"	127"	81"	4,570	560	7,500	2,930	90	32.5	32.5
26RKS	28' 5"	96"	134"	81"	5,970	790	8,400	2,430	86	65	32.5
26RLS	30'	96"	134"	81"	6,005	820	8,500	2,495	86	32.5	32.5
28BHS	30' 6"	96"	127"	81"	5,045	690	7,500	2,455	90	32.5	32.5
29QBH	33' 3"	96"	134"	81"	6,575	870	9,250	2,675	86	32.5	32.5
29RLDS	33' 5"	96"	134"	81"	6,990	955	9,500	2,510	86	65	32.5
32BHDS	35' 6"	96"	134"	81"	7,445	1,015	9,975	2,530	86	32.5	32.5
32TSBH	35' 6"	96"	134"	81"	7,775	815	10,500	2,725	86	32.5	32.5
33RLDS	35' 5"	96"	134"	81"	7,825	1,070	10,300	2,475	86	32.5	32.5
36BHDS	38'	96"	134"	81"	7,970*	965*	10,500	2,530*	90	32.5	32.5

The weights of certain options and/or option packages are not included in the UVW listed above. * Estimate. Visit your Jayco dealer or www.jayco.com for official specs.



JAY FLIGHT BUNGALOW 40FKS | DRIFTWOOD



JAY FLIGHT BUNGALOW 40FKS | DRIFTWOOD



JAY FLIGHT BUNGALOW 40FKS



america's favorite *destination*

Stay awhile in the Jay Flight destination trailers. Thanks to spacious floorplans, taller ceilings and a host of residential amenities, like standard ceiling fans and optional king-sized beds, your next camping destination is certain to be a good one.

JAY FLIGHT BUNGALOW FLOORPLANS

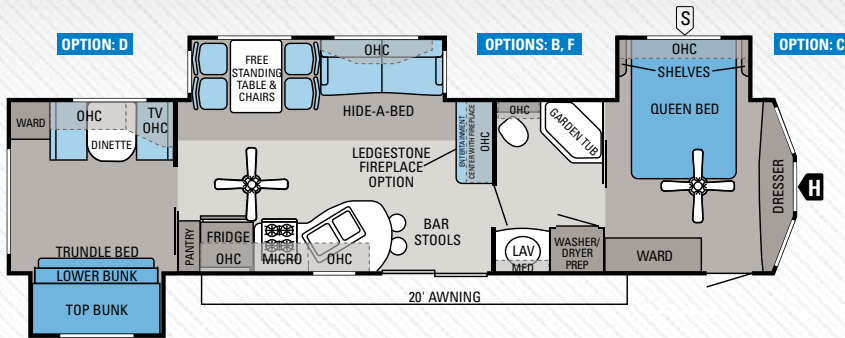

JAY FLIGHT BUNGALOW | 40BHS

Ext. Length: 40' 11" Ext. Height: TBD Unloaded Weight (lbs.): TBD Sleeps: 8-10

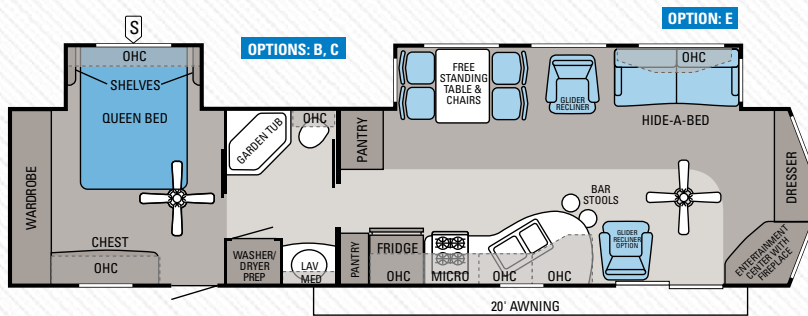

JAY FLIGHT BUNGALOW | 40FER

Ext. Length: 40' 11" Ext. Height: TBD Unloaded Weight (lbs.): TBD Sleeps: 4-6

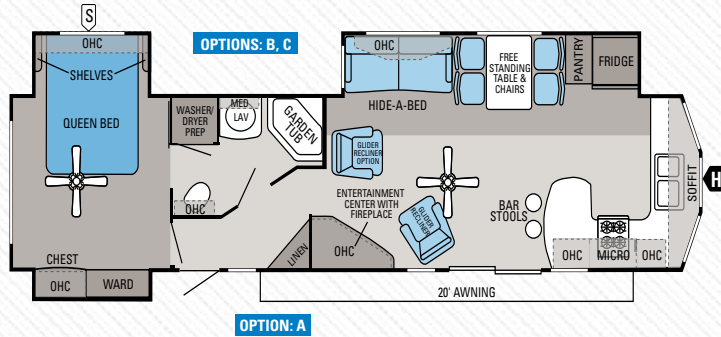

JAY FLIGHT BUNGALOW | 40FKS

Ext. Length: 40' 11" Ext. Height: TBD Unloaded Weight (lbs.): TBD Sleeps: 4-6

OPTIONS

OPTION A



OPTION B



OPTION C

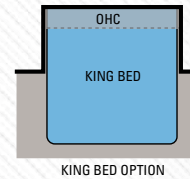

OPTION D



OPTION E

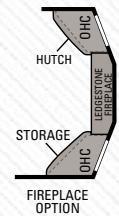

OPTION F

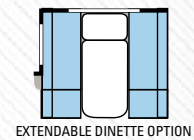

SPECIFICATIONS

FLOORPLAN	EXTERIOR LENGTH	EXTERIOR WIDTH	EXTERIOR HEIGHT (WITH A/C)	INTERIOR HEIGHT	UNLOADED VEHICLE WEIGHT (LBS.)	DRY HITCH WEIGHT (LBS.)	GROSS VEHICLE WEIGHT RATING (LBS.)	CARGO CARRYING CAPACITY (LBS.)	FRESH WATER CAPACITY (GAL.) (WITH WATER HEATER)	GRAY WASTEWATER CAPACITY (GAL.)	TOILET/BLACK WASTEWATER CAPACITY (GAL.)
40BHS	40' 11"	102"	TBD	96"	TBD	TBD	TBD	TBD	50	65	32.5
40FER	40' 11"	102"	TBD	96"	TBD	TBD	TBD	TBD	50	65	32.5
40FKS	40' 11"	102"	TBD	96"	TBD	TBD	TBD	TBD	50	65	32.5

The weights of certain options and/or option packages are not included in the UWV listed above.



CONSTRUCTION

and craftsmanship

At Jayco, we've built a reputation for superior construction and quality craftsmanship. We pride ourselves on always using top-quality materials and innovative manufacturing techniques. That commitment has led to our latest construction advancement, the all-new exclusive Magnum Roof System, 50 percent stronger than other roofs in the industry, built to outlast everything but your memories.



OUR NEW ROOF FEATURES ...

- 1 4 1/2" crowned wood trusses:** Uses 2"x 2" vertical studs to maximize load capacity, while oversized nail plates provide a tighter design
- 2 3/8" roof decking, screwed down at every seam:** More durable than typical stapled construction, provides fully walkable roof
- 3 Residential attic-style insulation:** Maintains interior temperatures while allowing for room to run wiring, reducing risky electrical shorts
- 4 One-piece, sidewall-wrapped Alpha Ply material:** Provides leak protection



WALL CONSTRUCTION

- 5 2" x 2" wooden studs:** Creates Jay Flight's long-lasting framework
- 6 Hand-tucked and glued fiberglass insulation (R-7):** Prevents insulation from sagging over time (vs. blanket-insulation technique), while helping increase insulation value near studs
- 7 Extra-wide corner seals:** Prevents leaks on the corner molds, baggage/entrance doors, window seals

FLOOR CONSTRUCTION

- 8 5/8" tongue-and-groove plywood deck on 2" x 3" wooden floor joists:** Moisture resistant, plywood holds up to the elements
- 9 Fiberglass insulation (R-7):** Maintains interior temperatures
- 10 Full-width outriggers:** Supports wall weight with no more than 4-foot spacing (vs. 8-foot spacing) and wall-to-wall, full-width design

FEATURES

- 11 Galvanized-steel wheel wells:** Reduces heat loss through floor; prevents floor damage in case of a blown tire
- 12 WaterWorks system:** Boasts 75-plus gallons of fresh water (n/a destination models)
- 13 Innovative, aerodynamic front profile:** Eliminates angled profile, increasing towability (n/a destination models)



eco advantage™ www.jayco.com/ecoadvantage

THE JAYCO ECOADVANTAGE IS OUR COMPANY'S COMMITMENT TO PROTECTING THE ENVIRONMENT. Scan this QR code with your smartphone to watch a video about our efforts and the impact we're having on our world.

STANDARDS AND OPTIONS

JAY FLIGHT TRAVEL TRAILER	JAY FLIGHT BUNGALOW
STANDARD EXTERIOR EQUIPMENT	STANDARD EXTERIOR EQUIPMENT
I-Class cambered structural-steel I-beam frame with fully integrated A-frame	Deluxe Graphics Package
Magnum truss roof system with one-piece seamless Alpha Ply 5/8" tongue-and-groove plywood floor decking	102" wide-body construction
Two-sided reflective foil insulation in flush-floor slideout floors	Magnum truss roof system with one-piece seamless Alpha Ply 5/8" tongue-and-groove plywood floor decking
Electric slideouts with enclosed gear system (slide models)	12" I-Class cambered structural-steel I-beam frame with fully integrated A-frame
30" x 72" main entrance door with step light	Two-sided reflective foil in flush-floor slideout floors
Exterior-marine grade speakers (2)	Electric-powered slideouts with enclosed gear system
G20 dark-tint windows	60" residential-style sliding patio door
Radial tires with galvanized-steel, impact-resistant wheel wells	Fold-away grab handles
E-Z Lube axles	Exterior marine-grade speakers (2)
Aerodynamic, rounded front profile with front diamond plate	Patio awning
Black tank flush sprayer	G20 dark-tint windows
30-amp power service	Radial tires with galvanized-steel, impact-resistant wheel wells
WaterWorks system with 75+ gallon freshwater capacity and durable, winterized Tuff Pex water lines	E-Z Lube axles
Stabilizer jacks with sand pads (4)	Fiberglass atrium-style front cap
	Detachable hitch
	Outside shower
	Black tank flush sprayer
	50-amp power service
STANDARD INTERIOR EQUIPMENT	STANDARD INTERIOR EQUIPMENT
Screwed-and-glued Glazed Concord Cherry cabinetry	96" interior height
Ball bearing drawer guides, 75-lb. capacity, full-drawer extension	120V ceiling fan in living room and bedroom
Large 60/40 acrylic kitchen sink with high-rise faucet	Screwed-and-glued Glazed Concord Cherry cabinetry
6-gal. gas/electric DSI Atwood water heater	Ball bearing drawer guides, 75-lb. capacity, full extension
3-burner range with 9,000-BTU SuperBurner and piezo igniter	18 cu. ft. residential-style 120V refrigerator with ice maker
6.3 cu. ft. Norcold double-door refrigerator	20" free-standing 4-burner gas range with oven
Atwood auto ignition furnace with wall thermostat	Large 60/40 deep-bowl acrylic kitchen sink with high-rise faucet
Cable/satellite prep	16-gal. gas/electric DSI Atwood water heater
Plywood bed, dinette and bunk bases	40,000-BTU Atwood auto ignition furnace with wall thermostat
J-Steel jack-knife sofa	Diamondflor vinyl flooring
Diamondflor vinyl flooring	Residential-grade carpet with padding
Residential-grade carpet with padding	Vertical patio door blinds
Porcelain stool with foot flush	Plywood bed and bunk bases
300-lb. rated bunks	Air mattress hide-a-bed with pull-out storage drawer
CUSTOMER VALUE PACKAGE (MANDATORY)	Electric fireplace
Dual 30-lb. propane bottles with easy access ABS cover	Cable/satellite prep
Outside shower	Porcelain stool with foot flush
Water heater bypass	300-lb. rated bunk beds
13,500-BTU A/C with directional/closeable vents	Deluxe pillowtop mattress
Microwave with built-in hood over range	Bedroom stereo speakers (2)
Oven	
ABS shower surround with bath skylight and fan	
ELITE PACKAGE	CUSTOMER VALUE PACKAGE (MANDATORY OPTION)
Aluminum rims, power tongue jack, 8 cu. ft. Norcold refrigerator with hardwood insert and deluxe pillowtop mattress	Dual 30-lb. propane bottles
	Stabilizer jacks (4)
THERMAL PACKAGE	15,000-BTU A/C with directional/closeable vents
Insulated, heated and enclosed underbelly and 2-sided reflective foil insulation in main roof and slideout roof	Water heater bypass
	Microwave with built-in hood over range
OPTIONS	Sink covers (2)
Adjustable-pitch electric patio awning	Multi-Media Premium Sound System CD/DVD with MP3 input jack
Thermal-paned windows	ABS tub surround with skylight and fan
Maxistor door (select models)	Quilted bedspread
Electric stabilizer jacks	
Electric tongue jack	THERMAL PACKAGE
Roof ladder	Insulated, heated and enclosed underbelly and 2-sided reflective foil insulation in main roof and slideout roofs
Spare tire with carrier	
Outside kitchen (select models)	OPTIONS
Outside bumper-mount grill	Adjustable-pitch electric patio awning
Bike rack/cargo tray system (select models)	Manual awning delete
Customer Value Package with 15,000-BTU A/C	Slideout awnings (2 or 3) (select models)
26" LED HDTV	Thermal-paned, tinted safety-glass windows
Free-standing table with 4 chairs (select models)	Spare tire
Bunks in lieu of dinette (26RKS)	Outside bumper-mount grill
Swivel rockers in lieu of dinette (2) (select models)	Roof ladder
Swivel rockers in lieu of door-side sofa (2) (select models)	20-gal. electric water heater
Door-side hide-a-bed sofa (33RLDS)	2nd glider/recliner (select models)
Hide-a-bed sofa (most models)	Ledgestone fireplace, facade and 40" LCD TV (select models)
Ledgestone fireplace with 32" LED HDTV (select models)	Extendable dinette (40BHS)
Linoleum living area (select models)	Linoleum living area (select models)
Quad bunk in lieu of standard bunk (select models)	Shower in lieu of garden tub
Trundle beds in lieu of J-Cube (select models)	King bed
Double bunk over double bed (select models)	Rear queen bed (select models)
	2nd A/C in bedroom (13,500-BTU)

INTERIOR DÉCORS

HAZELNUT



SANDALWOOD



DRIFTWOOD



WOOD



FOR A COMPLETE LIST OF STANDARDS AND OPTIONS, SCAN HERE WITH YOUR SMARTPHONE OR VISIT JAYCO.COM.



THE **Jayco**[®] family STORY

THE JAYCO STORY BEGAN IN 1968 WITH OUR FAMILY—THE BONTRAGERS. Lloyd Bontrager created an innovative, easy-to-use lifter system that led to a better fold-down camper. Loaded with more conveniences, he believed his camper would bring families closer together.

Since then, the Jayco family has grown. From our factory to our front office, from our salespeople to our suppliers, our family bond is four decades strong with the support of more than 300 Jayco dealers.

Together, we're helping make new family stories. **YOUR FAMILY STORY.**

welcome to the jayco family



Establishing a solid relationship with your local Jayco dealer is a key component in the enjoyment of your new Jayco. By purchasing from a local dealer, you will have a convenient location for sales, parts and service support. We hope you enjoy working with them as much as we do.



Jayco proudly sponsors Tread Lightly!, a nonprofit organization whose mission is to empower generations to enjoy the outdoors responsibly through education and restoration.

Unloaded Vehicle Weight (UVW): Sometimes referred to as "Dry Weight," UVW means the typical weight of this trailer as built at the factory. The UVW, as used in product literature and other promotional materials, does not include cargo, fresh water, propane, options or dealer-installed accessories.

Gross Vehicle Weight Rating (GVWR): GVWR means the maximum permissible weight of the trailer, including the UVW plus passengers, personal items, all cargo, fluids, options, and dealer-installed accessories. The GVWR is equal to or greater than the sum of the UVW and the CCC.



From RV insurance to extended warranties, JayPlus has it covered. Ask your Jayco dealer about our exclusive JayPlus program today.

Cargo Carrying Capacity (CCC): CCC means the maximum weight of all passengers, personal items, food, fresh water, propane, tools, other cargo and dealer-installed accessories that can be carried by the trailer. CCC is equal to or less than GVWR minus UVW. The addition of options will decrease the CCC.

Hitch Weight (HW): The hitch weight, as used in product literature and other promotional materials, does not include cargo, fresh water, propane gas, options or dealer-installed accessories. The addition of these types of items will either add to or subtract from the stated hitch weight.



As a Jayco owner, you can be part of the Jayco Jafari International Travel Club. Ask your dealer about the Jafari "flight" in your area, write Jayco or visit our website.

It is important for your safety and enjoyment that your tow vehicle be adequately sized and equipped to tow and handle the GVWR of the RV you select. Review weights and rating of your tow vehicle and consult a competent advisor for questions or advice. Whether you are new to RVing or a veteran, get a feel for the performance of your tow vehicle before heading out on the roadways. When you tow an RV, you must drive differently than when you drive a single vehicle. Practice hooking up, driving, backing up and braking in a safe environment or seek out professional instruction. Jayco affixes a weight label to each RV which lists weight information for that vehicle. See specifications chart inside.

Jayco, Inc., P.O. Box 460, Middlebury, IN 46540, www.jayco.com 

See dealer for further information and prices. All information in this brochure is the latest available at the time of publication approval. Jayco reserves the right to make changes and to discontinue models without notice or obligation. Photos in this brochure may show optional equipment and props for photography purposes. RVs built for sale in Canada may differ to conform to Canadian codes. ©2012 Jayco, Inc. 13-JFLT-PL 0611-60K Printed in U.S.A.